

■ Instruction Manual ■



POKETLE Soup Bottle 0.16L

Please read this instruction manual carefully and use your POKETLE correctly. Keep this instruction manual for future reference.

● Do not put in the following substances

Dry ice, carbonated drinks, etc.
Internal pressure may build, causing the plug to clog and the contents inside to leak out.

■ Before Use ■

- While we are committed to delivering high quality products, please check your product for any defects, cracks or damage before using it for the first time.
- If there are any problems with the product, do not use the product and instead, contact the nearest reseller.
- There may be a slight odor due to the nature of the materials, but this is not considered a defect.
- Do not use the product for any purpose other than keeping liquids warm or cold.
- The plastic bags used for packaging pose a choking hazard and other problems for infants and small children.
- After opening, please dispose of the packaging according to the sorting method of your residential area.
- Before use, use a soft sponge and wash it thoroughly with a mild kitchen detergent.
- Do not wash or disinfect it at high temperatures.

■ General Care ■

- While the body of the container is made from stainless steel, rust-like red spots may appear depending on the quality of the water or impurities present.
- Should such spots appear, mix 5 grams of citric acid with boiling water, fill the container with the mixture and leave it for about two hours. Then, clean it with a soft brush and rinse it thoroughly. (Do not use this cleaning method for any other parts).
- The container is not dishwasher safe. It may affect the functionality of the product as well as cause discoloration and rusting due to deformation.
- Do not wash or pour boiling water on parts other than the stainless-steel body.
- Avoid tampering with or overfilling the container because it may lead to product malfunction.
- Please do not use chlorine-based bleach, thinner, benzene, metal brushes, polishing powders or cleaners.
- Scratches and rust may damage the product.
- After washing the product, wipe off residual water to dry it immediately.
- For hygienic purposes, clean the product the same day it is used.
- For long-term storage, make sure the bottle is completely clean and dry before storing.



▲ DO NOT USE
Dishwasher Dried



▲ DO NOT USE
Microwave oven



▲ DO NOT USE
Disinfect in boiling water



▲ DO NOT USE
Cleaning the cap exterior at high temperature (May cause peeling)

■ Usage instructions ■

- Pour the hot or cold drink/food to keep them warm or cold. Bring hot drink/food to the boil. Pour the substance into the container and close the lid immediately. It is more effective by adding a small amount of pre heated hot water or pre-chilled water for a few minutes.
- Do not open the lid when its tilted with the hot drink and food inside. It can cause burn by increasing the inner pressure when food/drink are popping out and scattered.
- Do not tilt the container, make sure to drink slow when hot food/drink are inside. It can cause burn when its tilted suddenly, food/drink may come out vigorously.
- Food/drink needs to be consumed as early as (within 6 hours) at one.
- Do not pour raw product or something easy to get spoil. It may cause illness by consuming spoiled food/drink.
- Do not use when the sound of water occurs from inner part of vacuum double structure (vacuum layer). It may cause illness in case of consuming exuded vacuum layer water from the inner side of container.
- Be sure to close the lid to use the product. Check the cage with the correct silicone packing on the lid. Due to the structure of the lid, do not wash or disinfect it at high temperatures. Content may leak.
- Close the lid firmly. If the lid is not closed properly, vibration and impact can cause the plug to loosen and the beverage to leak. After installing the lid, tilt the product to check for leakage. When doing so, hold it over the sink and be careful not to burn yourself or soil your clothes.
- When the bottle is tilted or turned upside down, a small amount of beverage may be left in the lid, which might cause leakage. To avoid soiling your clothes or other items, close and open the lid carefully.

- The beverage should be filled up to the position indicated.

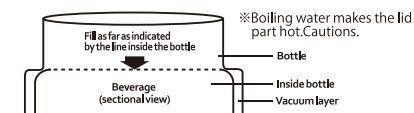

- When pouring hot liquid from the kettle, do not let the spout touch the mouth. Be careful with knocking over the bottle, as spillage may burn or scald the user.
- Be careful not to knock the bottle over as spillage may burn or scold the user and other items.
- When carrying a bottle, transport it with the bottle standing straight and the lid side up. Carrying the product while lying down can cause leakage.
- Make sure to rinse inside of the bottle with water after each use, even at outdoor. Due to gas generation by spoiled food, the internal pressure can increase, which may cause injuries and soil surrounding items, or the outer lid not opening, and food/drink to explode. Please contact a product manufacturer in case of lid not being able to open, do not add any heat to the lid, or try not to open the lid forcibly.
- Do not use any glad wrap-like in between inner lid and a container.
- Do not place product in the freezer as explosion or corrosion may occur.
- Do not heat it in a microwave. Sparks may fly, causing injury or destroying the microwave.
- Do not use it directly on the heat, on a stove, or on the grill. Do not place it in the refrigerator or freezer, etc.
- Do not leave it in a place like a car where temperature can go up with the cold beverage inside.

- Do not carry it around smart devices such as personal computers, tablets, or cameras.
- When placing the product into a bag or similar container, make sure the body stands vertically to prevent leakage.
- Do not use while driving a vehicle, motorized or otherwise.
- The sudden movements may cause spillage, causing burns, ruining clothes and soiling the interior of the car.
- While driving, avoid usage as it may be distracting and very dangerous.
- For storing ice, make sure the pieces are small enough to be put in without resistance.
- Otherwise, it can cause leaks and poor insulation.
- If hot tea is left in the container, the color of the tea may change.
- Due to the structure, the top of the bottle may become warm when hot water is added, but this is not abnormal.
- Keep away from direct heat, such as stoves or ovens.
- Plastic parts may be deformed or discolored otherwise.
- Be careful as the body heats up and may cause burns.
- Avoid dropping or hitting the bottle against hard surfaces as it can damage the product.
- Deformation of this product or breakage of the plug may cause leakage or decrease in heat insulation and cooling function.
- Keep out of reach of children.
- Storage of hot beverages may burn or scald the user. Be careful with tampering.
- For safety purposes, stop using immediately upon hearing rattle or cracking sound from the pressured part.
- Do not disassemble and attempt to repair it.
- When intending to dispose of this product, do so in accordance with the method of disposal approved by your local resident area.
- It might leave a smell in a container or silicone packing when pouring substance which has strong smell, but this is not considered a defect.
- Silicone seal a consumption article, it needs to be exchanged periodically. If you would like to exchange it, please inquiry the store where you purchased.

■ How to remove silicone packing ■

- Grasp the silicone packing with your fingers and remove it.
- Rinse them using sponge with neutral detergent for tableware.
- Silicon packing can be disinfected in the hot water.

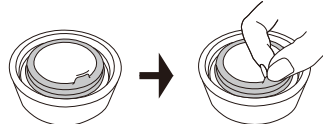

■ How to install silicone packing ■

- Install it according to the step of the lid with the side with the knob facing up. After placing it, confirm that there is no water leakage. Repeat the same process when leakage occurs.

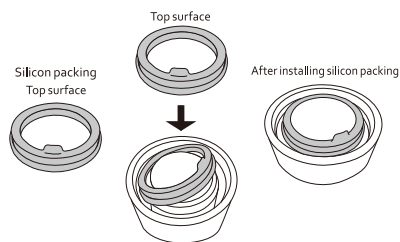

Color of Silicone packing is black the same as inner lid.

■ How to get replacement parts ■

silicon seal for replacement is sold separately.

Please purchase using the method below.

① Shop... Please contact the place of purchase.

Contact information for inquiry

If you have any questions please contact us.

DESIGN WORKS ANCIENT Co., Ltd.
12-7 Hatsuda, Terado-cho, Muko, Kyoto, Japan
mail: info@poketle.com



Product name: Portable stainless steel bottle
Actual capacity: 0.16L
(Weight of bottle only: approx. 155g)
Heat-retaining effect: 48°C or above (six hours)
Cold-retaining effect: below 14°C or below (six hours)
Materials used in product :
Bottle liner: Stainless steel
Trunk: Stainless steel
Cap: Polypropylene (inner), Stainless steel (exterior)
Silicone seal: Silicone rubber
Base cover: Silicone rubber
Dimensions: approx. 90mm (H) x 65mm (W)
Diameter: approx. 50mm

- Heat-retaining efficiency testing conditions:
Product filled with 95°C ± 1°C water and left it in room temperature of 20°C ± 2°C.
Heat-retaining efficiency refers to resultant temperature of the water after six hours.
- Cold-retaining efficiency testing conditions:
Product filled with 4°C ± 1°C water and left it in room temperature of 20°C ± 2°C.
Cold-retaining efficiency refers to resultant temperature of the water after six hours.